

INSTALLATION INSTRUCTIONS:

DESCRIPTION: INSTALLATION INSTRUCTION FOR FAVA CLUSTER SEATING TABLE.

DWG: INSTALL_MTB-2800-00000

REV: M01

NOTE : THESE INSTALLATION INSTRUCTIONS ARE APPLICABLE TO ALL 2800 SERIES PRODUCTS.

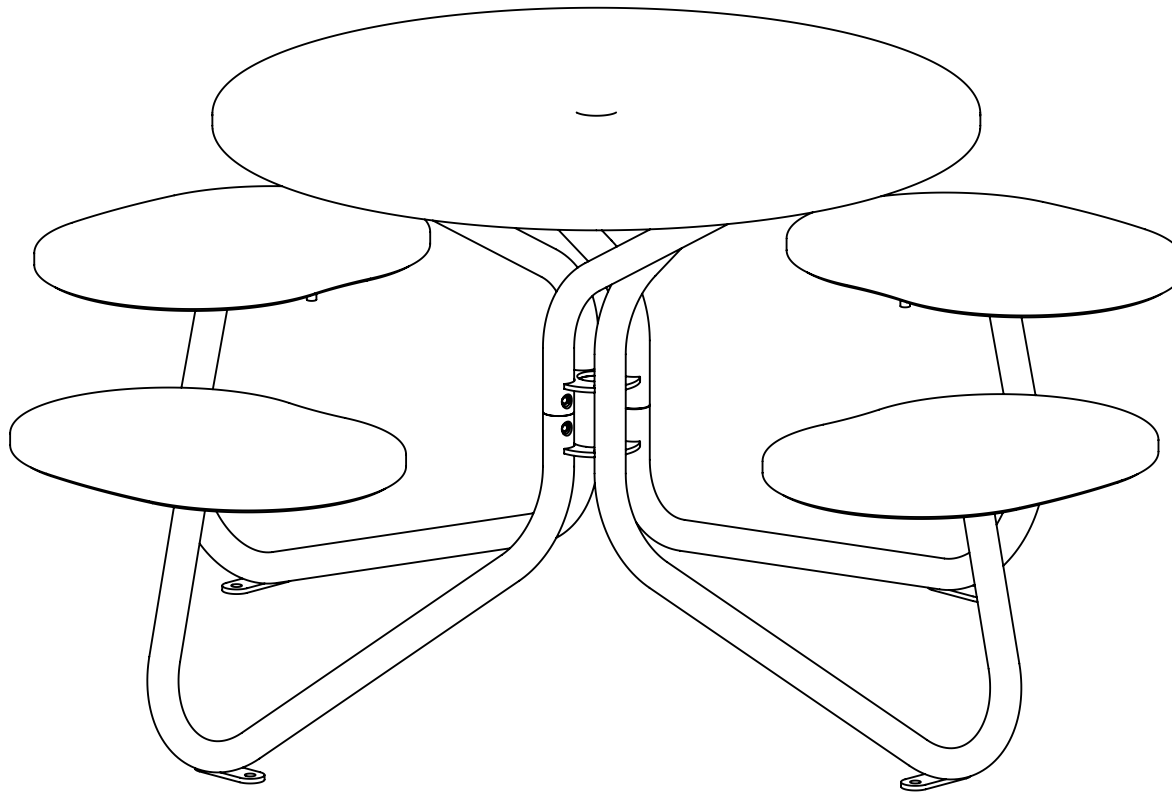

NOTES:

CAUTION! FAILURE TO FOLLOW INSTRUCTIONS COULD LEAD TO INJURY. ENSURE ALL STEPS ARE FOLLOWED AND FASTENERS ARE USED. TWO OR MORE PEOPLE ARE REQUIRED FOR INSTALLATION.

CAUTION! PARTS SHOULD NOT BE LEFT UNATTENDED AND SHOULD BE BOLTED TOGETHER IMMEDIATELY AFTER PLACING IN DESIRED LOCATION. SEATING IS NOT SAFE FOR USE UNTIL FULLY FASTENED TOGETHER AND ANCHORED DOWN.

CAUTION! ALL ASSEMBLIES MUST BE ANCHORED SECURELY TO A SOLID SURFACE. DO NOT LEAVE TABLE FREE STANDING. IT IS THE INSTALLER'S RESPONSIBILITY TO USE RECOMMENDED ANCHORS AND IDENTIFY AN SUITABLE SURFACE.

TOOLS:

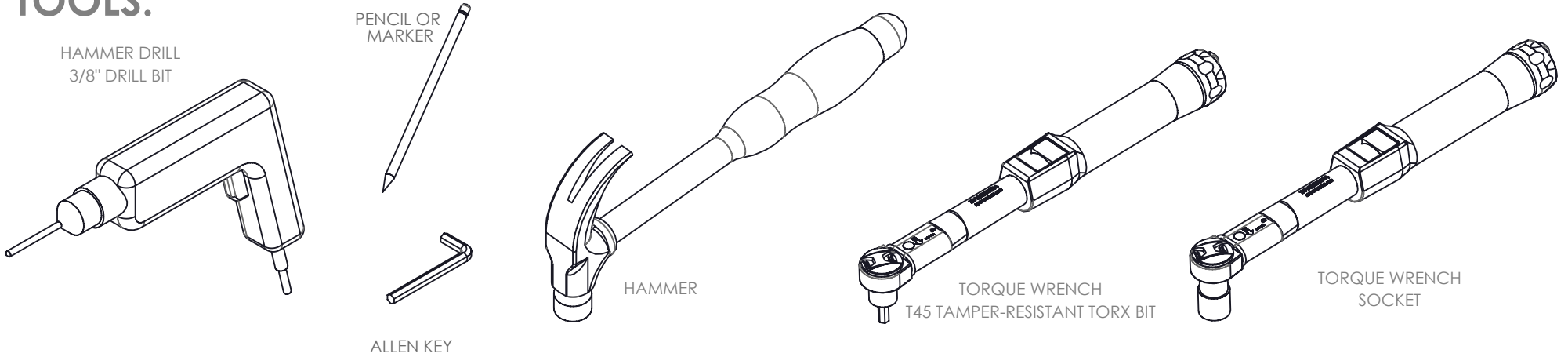

FASTENERS (NOT SUPPLIED):

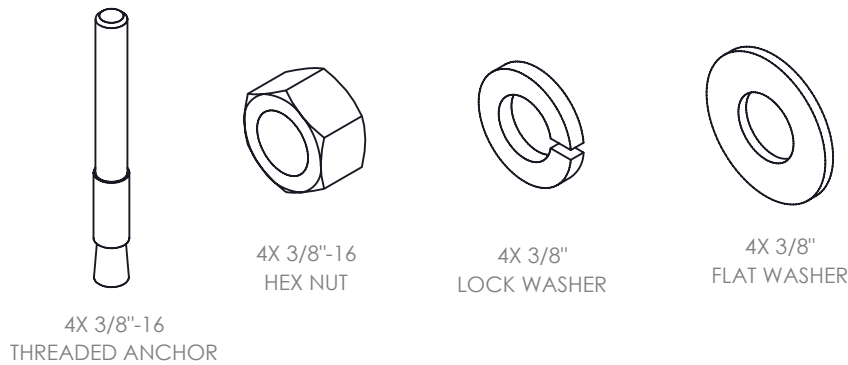

FASTENERS (SUPPLIED):

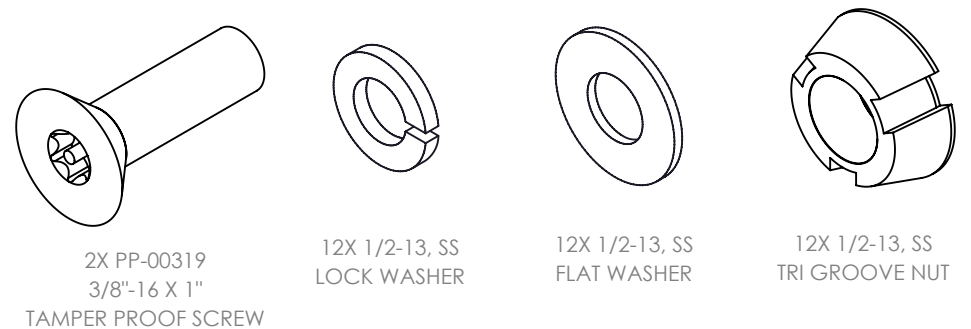

PARTS:

PLASTIC TABLE TOP SHOWN WITH OPTIONAL UMBRELLA MOUNT HOLE.

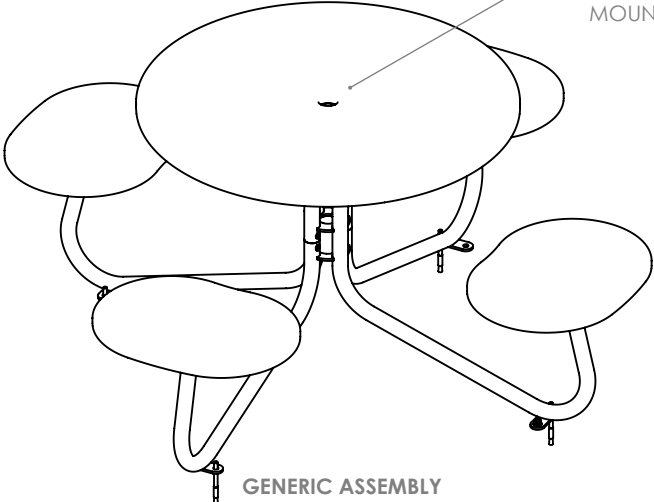

GENERIC ASSEMBLY
(AS SHIPPED AND RECEIVED WITH SEATING OPTION ATTACHED)

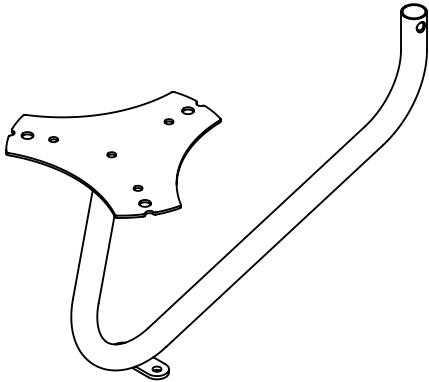

REMOVABLE LEG
(OPTIONAL)

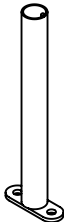

WHEEL CHAIR ACCESS LEG
(OPTIONAL)



LEG CONNECTOR

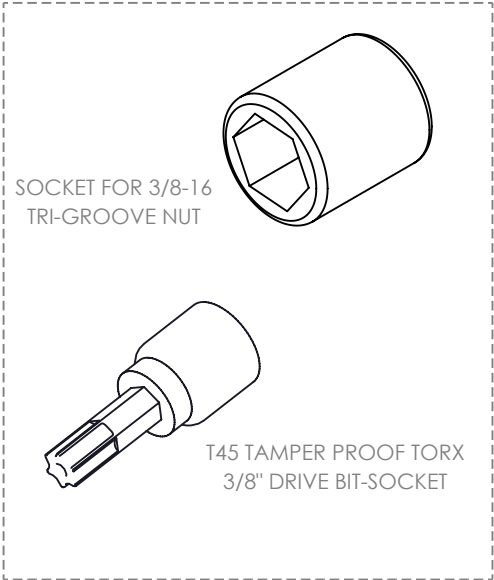

SOCKET FOR 3/8-16 TRI-GROOVE NUT

T45 TAMPER PROOF TORX 3/8" DRIVE BIT-SOCKET

INSTALLATION TOOL KIT (MMP-9999-00011)
(OPTIONAL PURCHASE)

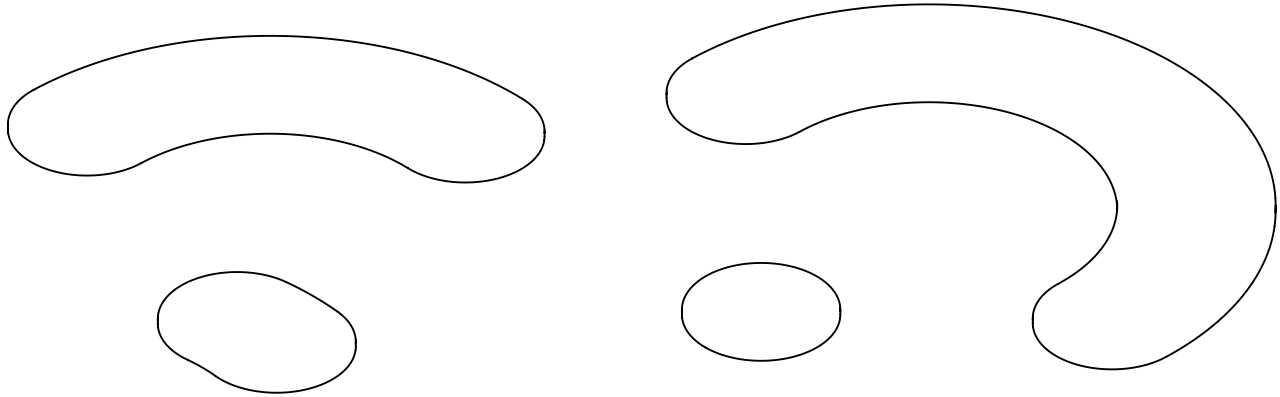

VARIOUS SEATING OPTIONS

(DIFFERENT COMBINATIONS CAN BE APPLIED BASED ON CUSTOMER ORDER)

1 RECEIVING A FULLY ASSEMBLED FAVA CLUSTER SEATING TABLE:

PLACE THE FULLY ASSEMBLED, FAVA CLUSTER SEATING TABLE, IN THE DESIRED LOCATION AND ORIENTATION. PROCEED TO MARK THE MOUNT FEET HOLES WITH A PENCIL OR MARKER AS SHOWN. THE MARKED LOCATIONS SHOULD RESULT IN A CIRCLE, APPROXIMATELY 52 1/4" IN DIAMETER. **NOTE:** AN ALTERNATE HOLE LOCATION IS MARKED FOR CONFIGURATIONS THAT USE A WHEEL CHAIR ACCESS LEG.

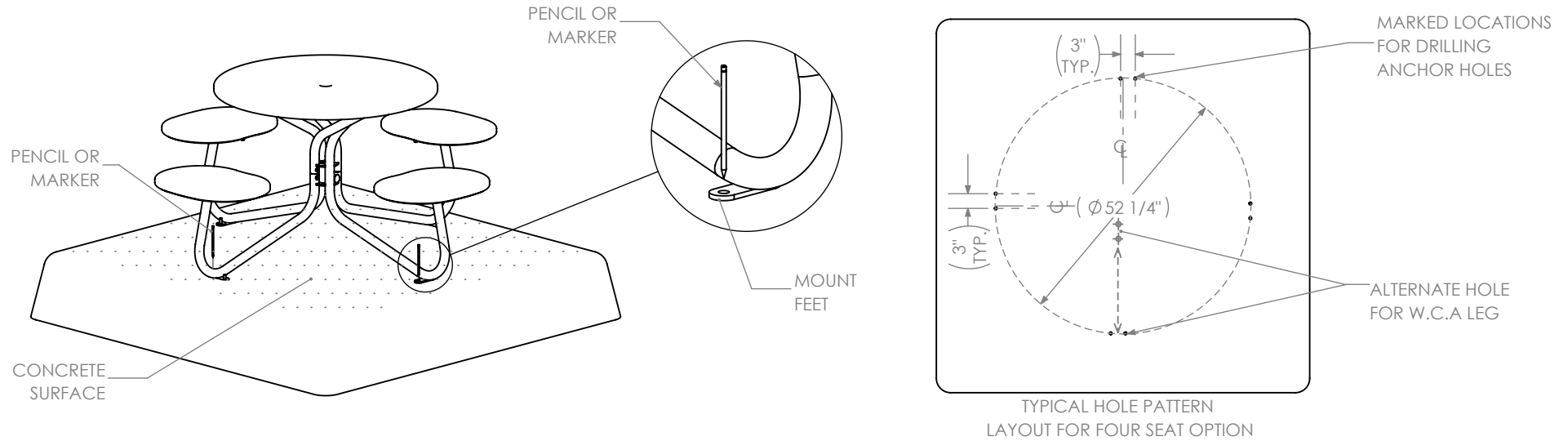

2 SET ASIDE, THE TABLE ASSEMBLY. USE A HAMMER DRILL TO PILOT THE HOLES, TO THE REQUIRED DIAMETER, FOR EIGHT ANCHORS. **NOTE:** THE PILOT HOLE SIZE AND DEPTH SHOULD FOLLOW THE ANCHOR MANUFACTURERS SPECIFICATIONS. NEXT, INSERT ANCHORS TO THE APPROPRIATE DEPTH. THE ANCHORS SHOULD PROJECT APPROXIMATELY 1 INCH FROM THE MOUNTING SURFACE. TAP THE ANCHORS INTO PLACE WITH A HAMMER IF NECESSARY.

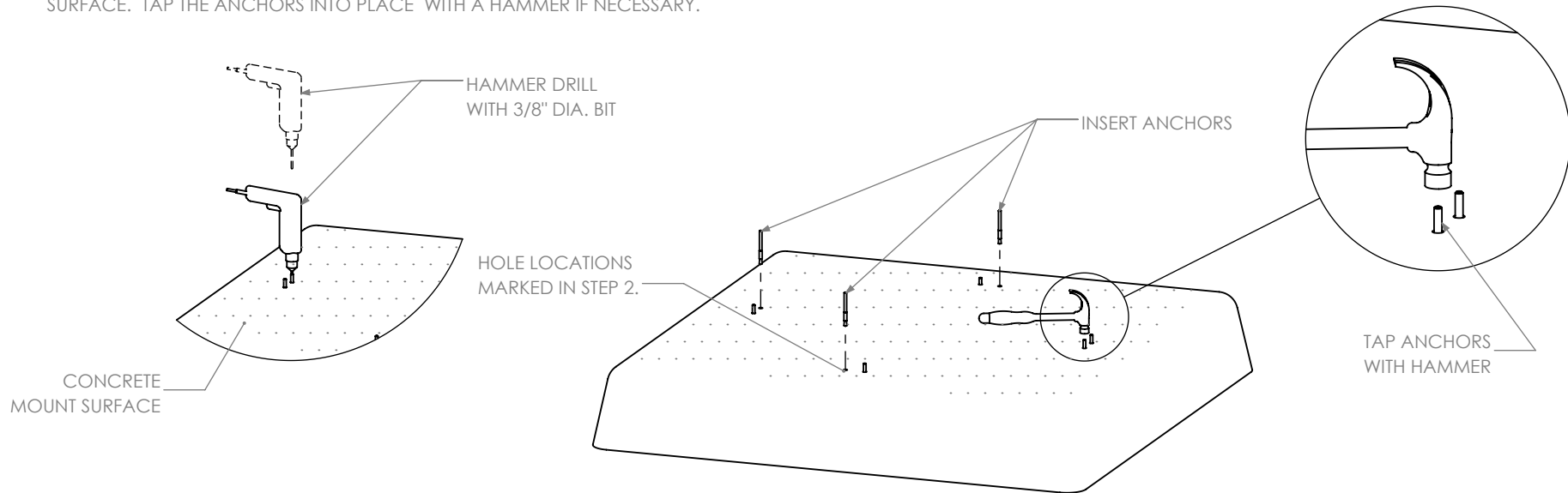

- 3** PLACE THE TABLE ASSEMBLY OVER THE INSERTED ANCHORS SO THAT ALL MOUNT HOLES ARE ALIGNED WITH EACH CORRESPONDING ANCHOR. NEXT, FASTEN MOUNTING HARDWARE TO EACH ANCHOR POSITION AS SHOWN. APPLY UP TO 20 FT-LBS OF TORQUE, ON EACH CONNECTION USING A TORQUE WRENCH. ANCHORS AND MOUNTING HARDWARE IS NOT SUPPLIED.

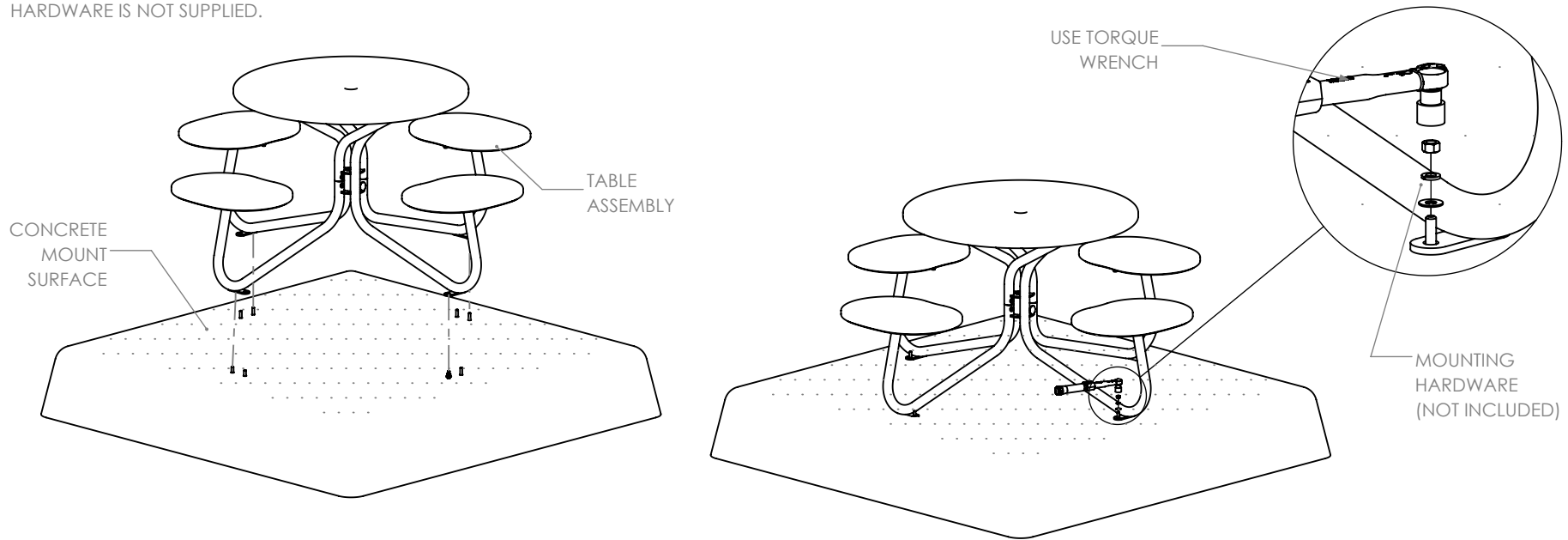

- 4** INSTALLATION COMPLETE.
(SIMILAR FOR VARIOUS CONFIGURATIONS.)

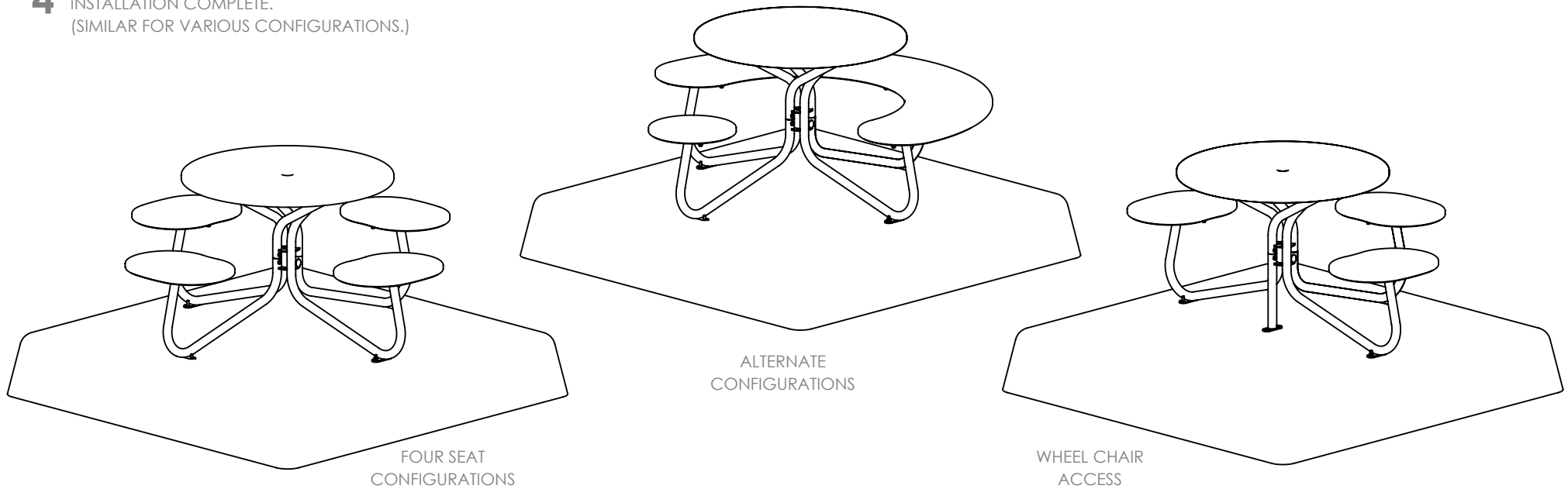

5 RECEIVING A PARTIALLY ASSEMBLED FAVA CLUSTER TABLE:

SOME PACKAGING OPTIONS MAY INCLUDE THE SHIPMENT OF A PARTIALLY ASSEMBLED, FAVA CLUSTER SEATING TABLE. IN THIS CASE, THE PRODUCT MUST BE FULLY ASSEMBLED BEFORE INSTALLATION.

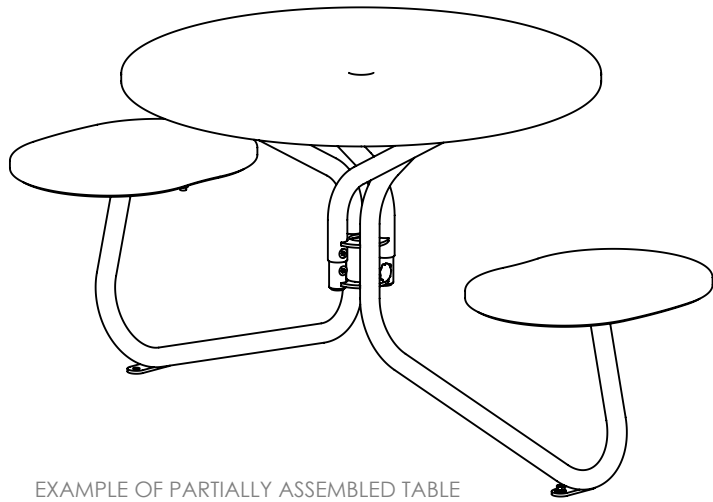

EXAMPLE OF PARTIALLY ASSEMBLED TABLE

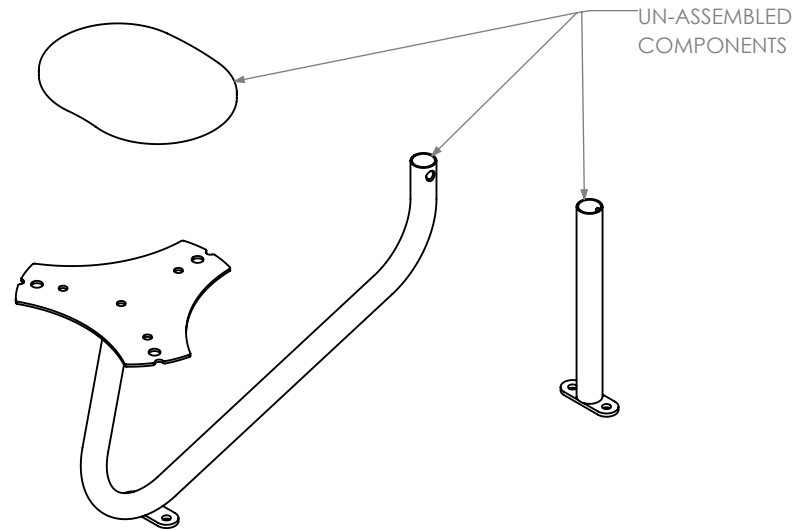

6 FIRST, INSERT LEG CONNECTOR INTO WELDED FRAME AS SHOWN, AND FASTEN USING PROVIDED HARDWARE. DEPENDING ON CHOSEN CONFIGURATION, ATTACH THE REMOVABLE SEAT LEG (OR WHEELCHAIR ACCESS LEG) TO THE LEG CONNECTOR AS SHOWN. USE A TORQUE WRENCH, WITH A TORX BIT, TO TIGHTEN THE LEG CONNECTION HARDWARE TO 20 FT.LBS.

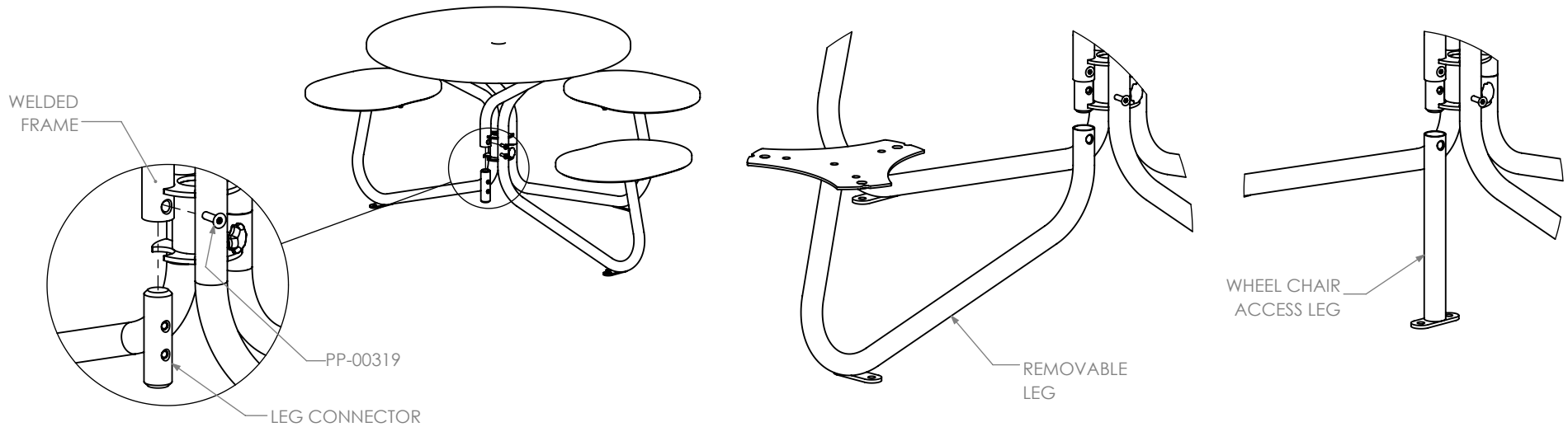

7 ADD THE REQUIRED SEAT ASSEMBLIES TO THE TABLE FRAME, ACCORDING TO THE APPLICABLE CONFIGURATION. USE THE SUPPLIED 1/2" HARDWARE TO SECURE THE SEATS TO THE FRAME. AN OPTIONAL INSTALLATION TOOL KIT (**MMP-9999-00011**) IS AVAILABLE FOR PURCHASE.

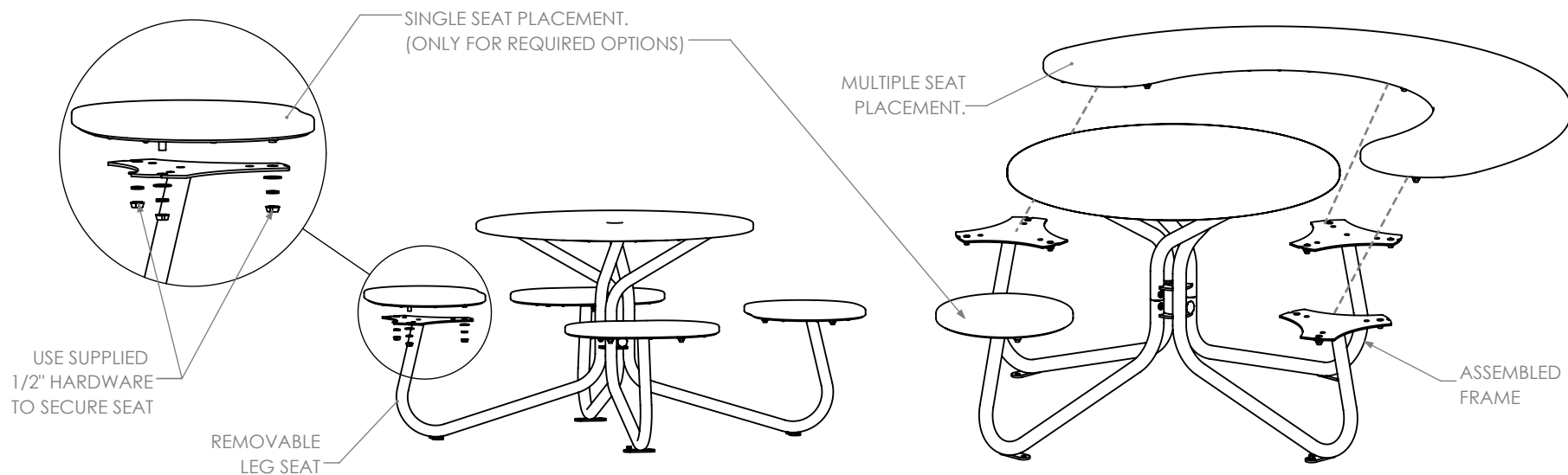

8 ONCE THE FAVA CLUSTER SEATING TABLE IS FULLY ASSEMBLED, THEN REFER TO STEP 1 OF THIS INSTRUCTION MANUAL, TO COMPLETE THE INSTALLATION,

